

# TEPRA Lite

## LR5E User's Manual

### Contents

- "TEPRA" Lite main unit
- User's manual (This document: with warranty)

Thank you for purchasing this LR5E "TEPRA" Lite. Please read this manual carefully before using this product and use it correctly. In addition, this manual also serves as a warranty certificate. Keep it in a place where you can refer to it at any time and do not lose it.

#### "TEPRA" Lite tape is thermal paper.

In a general indoor environment (normal temperature and humidity, 500 lux under fluorescent lights), labels last about 1 year, but these labels are not suitable for locations with strong light such as direct sunlight, wet locations, or environments with high temperature and humidity. Also, please understand that the tape surface and the characters written on it lose color if the labels are rubbed with a hard object.

- Only "TEPRA" Lite and "coharu" tape can be used.
- Please understand that if this device is used near a television, radio, or other such receiver, it may cause noise.
- Every effort has been made to ensure the accuracy of this document, but if you should find an error, please let us know.
- Company and product names in this document are trademarks or registered trademarks of the respective companies.

## Main specifications

<b>Input</b>	English text input
<b>Characters</b>	8 characters by 1 line Monochrome LCD display
<b>Maximum number of input characters</b>	62
<b>Built-in characters</b>	759 English letters and numbers 62 Symbols and icons 697
<b>Printing method</b>	Thermal printing
<b>Print width</b>	about 9 mm (180 dpi • 64 dots)
<b>Tape supported</b>	"TEPRA" Lite tape and "coharu" specialized masking tape
<b>Power supply</b>	AAA alkaline batteries x 4
<b>Dimensions</b>	About 90 x 115 x 37 mm
<b>Weight</b>	About 195 g (excluding tape and batteries)
<b>Operating environment</b>	15 - 35°C, 30 - 80% relative humidity (no condensation allowed)
<b>Storage environment</b>	-10 - 55°C, 5 - 80% relative humidity (no condensation allowed)

## Safety precautions Always observe these precautions!

The following precautions must always be followed in order to prevent injury to the user and others, and also damage to assets.

- The degree of injury and damage arising from incorrect usage by ignoring the displayed instructions is as follows.

**Danger** This indicates precautions for which incorrect usage "can result in the highly imminent possibility of death or serious injury".

**Warning** This indicates precautions for which incorrect usage "may result in death or serious injury".

**Caution** This indicates precautions for which incorrect usage "may result in injury or physical damage".

- The following icons differentiate precautions to be followed.
  - ⚠ The label indicates a danger, warning, or caution to pay attention to.
  - ⊘ The label indicates a prohibited operation.
  - ! The label indicates mandatory operation.

### Danger

#### [Handling batteries]

- ! If the alkaline solution from a battery gets in your eyes, it could cause blindness or other injury. If this happens, do not rub your eyes, but wash them out immediately with plenty of clean tap water, then seek medical attention.

### Warning

#### [Handling batteries]

- ! Improper use of batteries can cause leakage, overheating, and explosion which could result in injury or equipment damage. Use batteries correctly, as explained on their labels and the precautions written on the package.

- ⊘ Do not use new batteries together with old batteries or mix batteries from different brands. The difference in their characteristics can cause leakage, overheating, and explosion.

- ! If this product will be left unused for a long period of time or its batteries are run down, take them out. Gases generated in the batteries can cause leakage, overheating, and explosion which could damage the product.

### Caution

#### ["TEPRA" Lite tape]

- ⚠ Depending on the material of the adherend such as vinyl chloride that contains plasticizer, the environmental conditions, or the state when the label is attached, the glue from the label can stick to and damage the adherend. Please understand that we bears no responsibility whatsoever for any damage or lost earnings caused by this.

#### [Others]

- ⊘ Do not step on, drop, or strike this product or subject it to strong force or mechanical shock, let it get wet, or disassemble or alter it. Doing so could cause a malfunction, fire, or electrical shock.

- ⊘ Do not operate this product in any way not found in this manual. Doing so could cause an accident or malfunction.

- ⊘ Do not touch anywhere near the tape outlet during printing or cutter operations. Your finger could be cut.

Dispose of used batteries in accordance with the local laws and ordinances in your area.

Use only AAA Alkaline batteries. Rechargeable batteries cannot be used.

### FCC Compliance Statement

#### For United States Users

**Note:** This equipment has been tested and found to comply with the limits for a Class B digital device, pursuant to Part 15 of the FCC Rules. These limits are designed to provide reasonable protection against harmful interference in a residential installation. This equipment generates, uses and can radiate radio frequency energy and, if not installed and used in accordance with the instructions, may cause harmful interference to radio communications. However, there is no guarantee that interference will not occur in a particular installation. If this equipment does cause harmful interference to radio or television reception, which can be determined by turning the equipment off and on, the user is encouraged to try to correct the interference by one or more of the following measures:

- Reorient or relocate the receiving antenna.
- Increase the separation between the equipment and receiver.
- Connect the equipment into an outlet on a circuit different from that to which the receiver is connected.
- Consult the dealer or an experienced radio/TV technician for help.

**Warning:** Changes or modifications not expressly approved by the manufacturer could void the user's authority to operate the equipment.

### Disposal of Old Electrical & Electronic Equipment (Applicable in the European Union and other European countries with separate collection systems)

#### For European Users



The crossed out wheeled bin label that can be found on your product indicates that this product should not be disposed of via the normal household waste stream. To prevent possible harm to the environment or human health please separate this product from other waste streams to ensure that it can be recycled in an environmentally sound manner. For more details on available collection facilities please contact your local government office or the retailer where you purchased this product.

This information only applies to customers in the European Union, on waste electrical and electronic equipment (WEEE) and legislation transposing and implementing it into various national legal systems, and to customers in countries in Europe, Middle East and Africa (EMEA) where they have implemented equivalent regulations.

For other countries, please contact your local government to investigate the possibility of recycling your product.

## When these message appears

**Low battery** The batteries have run down. Turn off the power and replace all the batteries with new ones.

**Overheated!** The printhead has overheated. Stop printing for a while (about 5 minutes).

## Troubleshooting

Nothing is displayed when you press .

- **Are the batteries correctly installed?**  
If the batteries are installed backwards, the power does not come ON.

- **Have the batteries run down?**  
If the batteries are run down, the power does not come ON. Replace all the batteries with new ones.

### The product does not operate normally.

- The "TEPRA" Lite may have malfunctions due to static electricity or other causes. If it does not operate properly, initialize it with the following procedure.

- 1 Press to turn off the power.
- 2 While pressing and , press .
- 3 When "Reset defaults?" is displayed, press .

## When printing is faint

Use a baby cotton swab to gently wipe the printhead clean.

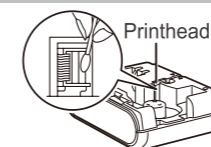

## When the front and rear margins on the tape have different lengths

Adjust the rear margin length. The adjusted value is retained even after the power is turned off.

- 1 With the power off, press while pressing .
- 2 When "End margin" is displayed, press repeatedly and select the desired end margin (-5 mm to +5 mm).
- 3 Press .

## After-the-sale service

### Warranty

Check that the store and date of purchase have been entered correctly on the warranty, then accept it from the store of purchase. Read the warranty and the details of the warranty stipulations, then store the warranty carefully.

### Repairs

Repairs are carried out within the warranty period according to the warranty stipulations. Please bring the product and the warranty to the store of purchase. After the end of the warranty period, if the product can be repaired, it will be repaired for a fee upon your request. Please bring the product to the store of purchase. When this product is repaired or inspected, the data stored in it is cleared. Please understand.

### MANUFACTURER

#### KING JIM CO., LTD.

No.10-18, 2-chome Higashi-Kanda, Chiyoda-ku Tokyo, 101-0031 JAPAN  
Tel:+81-3-3864-0808 <http://www.kingjim.co.jp/english>

### Importers and Inquiries

If you have any questions or requests concerning after-the-sale service, please consult the store of purchase or our Customer Service Department.

**VIETNAM** KING JIM (VIETNAM) CO., LTD. REPRESENTATIVE OFFICE  
SAI GON RIVERSIDE OFFICE CENTRE  
Room 906, 9th Floor, 2A-4A Ton Duc Thang Street, District 1, HCMC.  
TEL : +84 - 28 - 3939 - 3922  
E-mail : customer@kingjim.com.vn  
URL : www.kingjim.com.vn

**INDONESIA** P.T. KING JIM INDONESIA Jakarta Sales Office  
Gardenia Boulevard JL.Warung Jati 12, Lt.3C  
Pejaten Jakarta Selatan 12510 Indonesia  
TEL : +(62)21-29048707  
E-mail : sales@kingjim.co.id

**SINGAPORE** CO-LETA TRADING PTE. LTD.  
43 Gul Circle Singapore 629578, SINGAPORE  
TEL : + (65) 6863-3566  
FAX : + (65) 6863-3155

**TAIWAN, R.O.C.** Longho Stationery co.,Ltd.  
135, Taiyuan Road, Taipei, TAIWAN, R.O.C.  
TEL : 886-2-2555-2424  
URL : <http://www.longho.com.tw/>

**HONG KONG** KING JIM (HK) CO.,LIMITED  
Room 1408, Beverly House, 93-107 Lockhart Road,  
Wanchai, HONG KONG  
TEL : +(852) 2838-0886

**UAE** Al Nahar Electronics Trading  
P.O.Box 33108 Sharjah UAE  
TEL : +971 65439004, 65437344 ext: 210  
FAX : +971 65439005, 65437465

**USA** JPT AMERICA, INC.(Headquarters)  
1760 Buchanan St. STE 1 San Francisco, CA 94115 U.S.A.  
TEL : + (1) 415-814-2110  
URL : <http://www.jptamerica.com/>

**GB** JPT EUROPE Ltd.  
24-25 Denman Street, London W1D 7HU, U.K.  
TEL : +44 (0)20-7839-4839  
URL : <http://www.jpbooks.co.uk/>

#### JAPAN KINGJIM CO., LTD.

No.10-18, 2-Chome Higashi-Kanda, Chiyoda-ku, 101-0031 Tokyo, JAPAN  
When you bought this product in Japan, please contact through the address below.  
URL : [http://kingjim.jp/contact\\_us/](http://kingjim.jp/contact_us/)  
URL : [http://www.kingjim.co.jp/sp/english/tepra\\_title/5e/](http://www.kingjim.co.jp/sp/english/tepra_title/5e/)

## Operation

### 1. Press to turn the power ON.

#### Note

- To reset the input data, press to turn off the power, then turn the power back ON again.
- To restore the data input from the previous time, immediately after turning the power ON, press either or , then press .
- If there is no operation for 5 minutes, the power goes off automatically.

### 2. Press repeatedly to select input mode.

#### <Two input modes>

- ABC input: Inputs capital letters.
- abc input: Inputs small letters.

\* Input mode can be switched during text input.

### 3. 1 Input characters

#### Character editing

: Move the cursor.

: Clears the character to the left of the cursor one character at a time or cancels the current item selection.

: Inputs a space.

: Confirms the item selected.

### 4. Press to print.

#### Caution

Do not touch the tape or press the Cut button during printing. The tape might jam.

### 5. When the printing is finished, press the Cut button to cut the tape.

You can make labels like this!  
\* The pictures of this label is not its actual size.

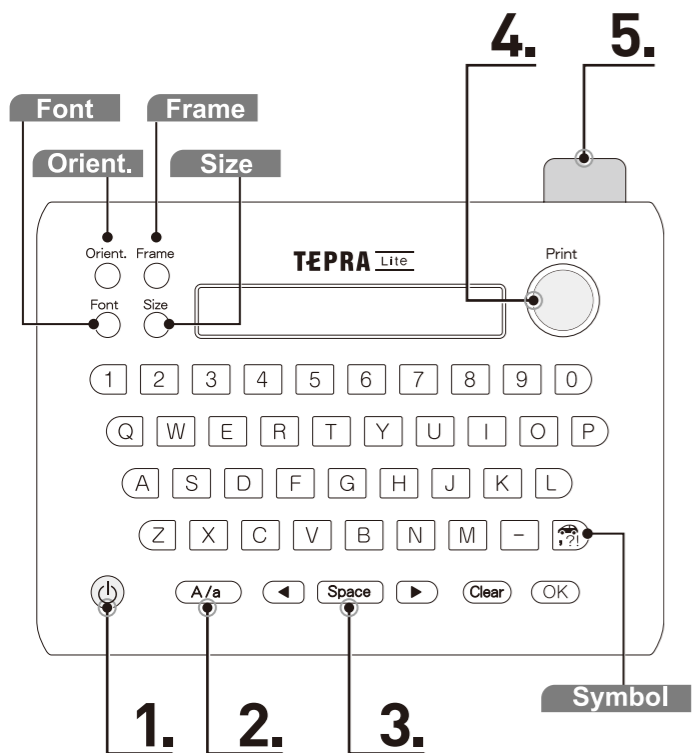

#### <Symbol Description>

: ON/Stand-by : Hot Surface : Direct current

## Installing the batteries and tape

### 1 Turn the main unit over and remove the cover.

#### Caution

Make sure that the power is off before removing the cover.

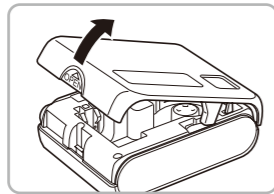

### 2 Insert the four AAA alkaline batteries (sold separately).

Make sure that the and ends are facing correctly.

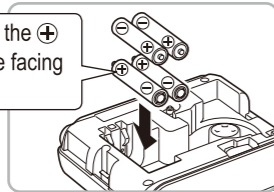

### 3 Mount the tape with its tip extended.

Make sure that the tape is facing the correct direction.

#### Caution

If the backing paper for the tape is peeled off, the tape may jam during printing.

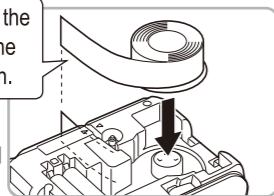

### 4 Turn the tape with a finger to return the tip of the tape to the position.

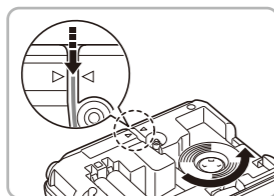

### 5 Line up the tab with the groove and fit the cover into place.

Fit in firmly until you hear the cover snap into place.

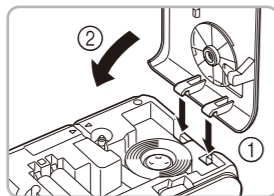

### Orient. Changing the print orientation

Can be changed at any time during text input!

#### 1 Press repeatedly to select the print orientation.

#### Caution

For vertical printing, the balance may deteriorate for some characters.

### Frame Attaching a frame

Can be changed at any time during text input!

#### 1 Press .

#### 2 Press repeatedly to select the frame.

#### 3 Press .

#### <Frame list>

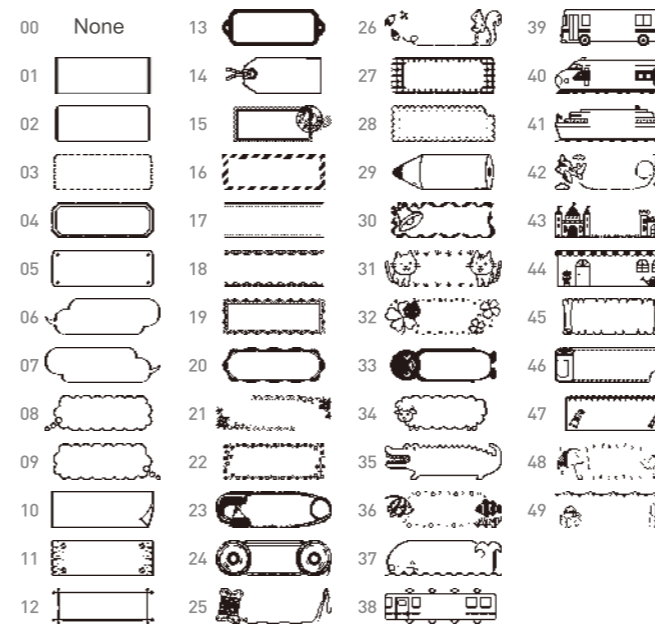

### Font Changing the font

Can be changed at any time during text input!

#### 1 Press repeatedly to select the font.

#### <Seven fonts>

Gothic	ABC123	Cute	<i>ABC123</i>
Helvetica	ABC123	Typewriter	ABC123
Handwriting	ABC123	Graffiti	ABC123
Antique	<i>ABC123</i>		

### Size Changing the font size

Can be changed at any time during text input!

#### 1 Press repeatedly to select the font size.



\* The pictures of these labels are not their actual sizes.

#### Caution

For some combinations of font and font size, characters will overlap with the frame and be corrupted.

### Symbol Entering symbols and icons

Can be changed at any time during text input!

#### 1 Press repeatedly to move the cursor to the position of the symbol or icon you want to enter.

#### 2 Press .

#### 3 Press repeatedly to select the category.

#### 4 Press .

#### 5 Press repeatedly to select the symbol or icon.

#### 6 Press .

#### <Symbol List>

